

CONTACTS:

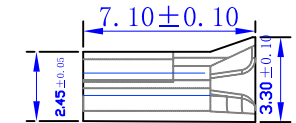
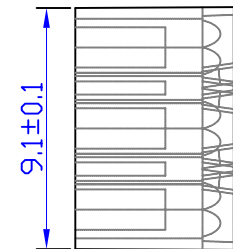
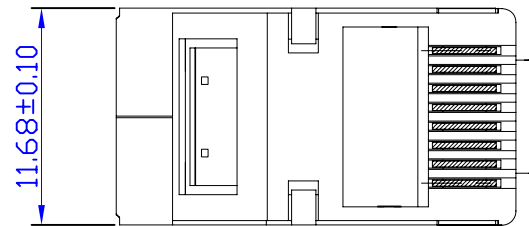
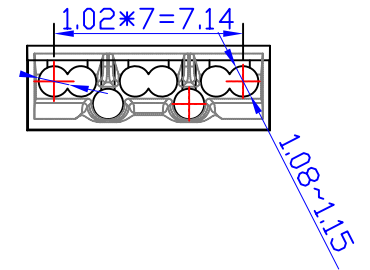
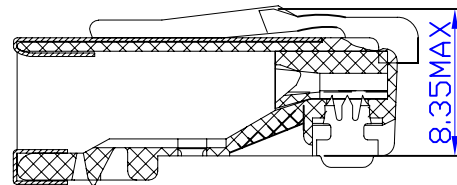
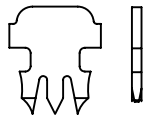

SPECIFICATION

1. ELECTRICAL

UL Applications:250 Volts AC MAX., at 2 AMPS
 Dielectric Strength:1000 AC(50-60HZ)0.5mA 1min
 Insulation Resistance:1000MΩMIN
 Contact Resistance:30mΩMAX

2. MECHANICAL

Cable-to-plug Tensile Strength:17bs. (7.7Kg)
 Durability:750 cycles MIN

3. MATERIAL & FINISH

Housings:**POM**
 Shell:H65 0.25mm Plated Nickel
 Color:**Black**
 Contacts:0.35mm H65,nickel plating
 followed with gold plating
 Gold plating:3u"

| | | | | | |
|-------------|---------------------------------|----------------------------|---------------|-----------|-------|
| SHEET | PAGE 1 OF 1 | <h1>Coorle Technology</h1> | | | |
| SCALE | 1:1 | | | | |
| MATERIAL | PC&Qsn6.5-0.1 | | | | |
| DESCRIPTION | CAT6 8P8C 上六下二 二件式1.1mm三叉 包壳 | DIMENSION IN mm | .X±0.20 | .X° ±5° | |
| PART No. | | | .XX±0.10 | .XX° ±2° | |
| | | | .XXX±0.05 | .XXX° ±1° | |
| DESIGNED | XU JUN | CHECKED | LIN SHU SHENG | APPROVED | JACKY |